

# Village Badshahpur SECTOR 68

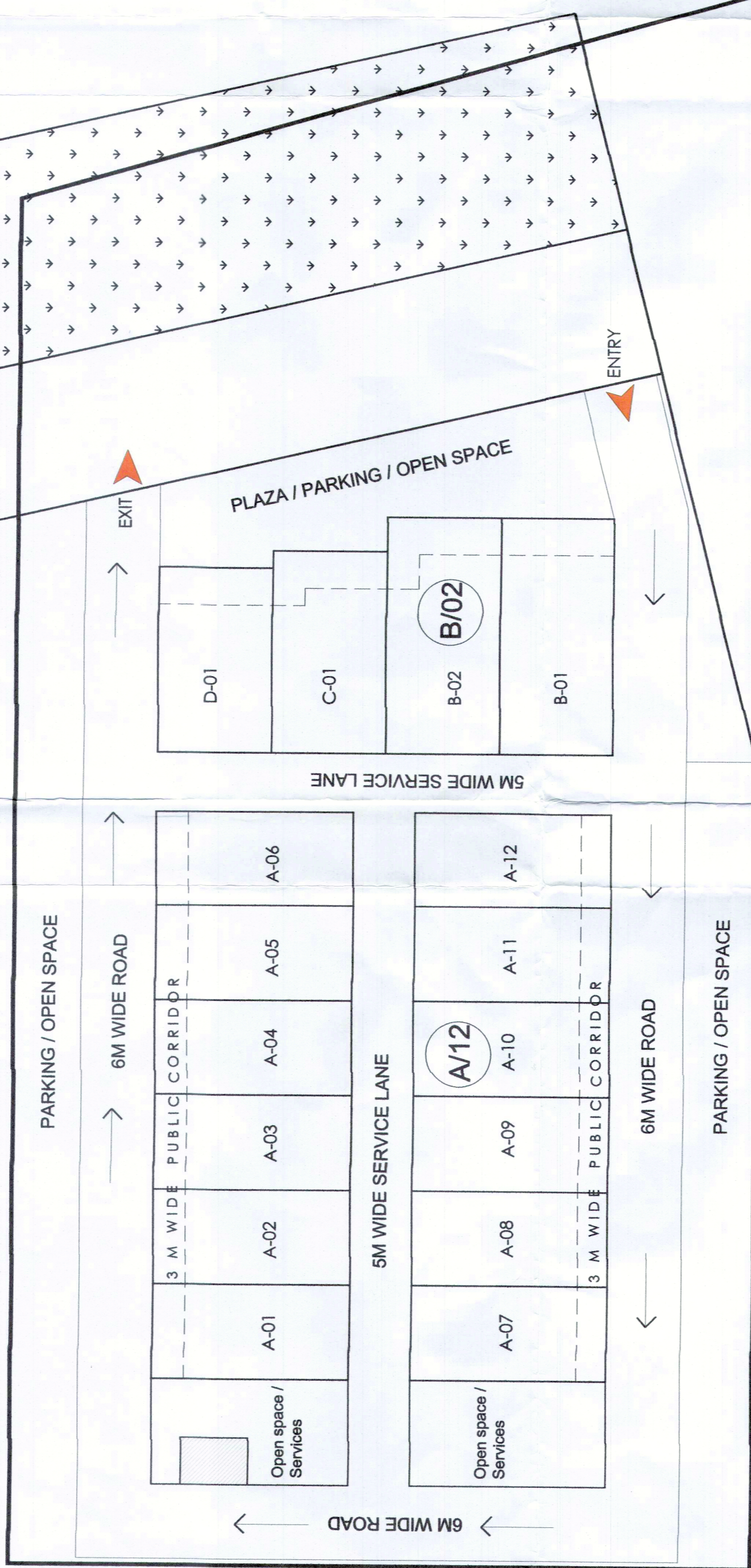

24m Wide Road

12m Wide Service Road

DAYA N. SINGH DATED 8741 DATED. 15-11-2022  
 T.C-4514  
 L NO. 185 / 11.11.2022

- (RAIN AVTAR DAS) JP (HC)
- (SUNAY NARANG) ATP (HC)
- (R.S. BATHI) DTP (HC)
- (HITESH SHARMA) STP (HC)
- (P. S. SINGH) ETP (HR)
- (T.L. SATYAPRAKASH, IAS) DG, TCP (HR)

60m Wide Sohna Road

To Sohna

To Gurugram

12m Wide Service Road

18m Wide Green Belt

18m Wide Green Belt

18m Wide Green Belt

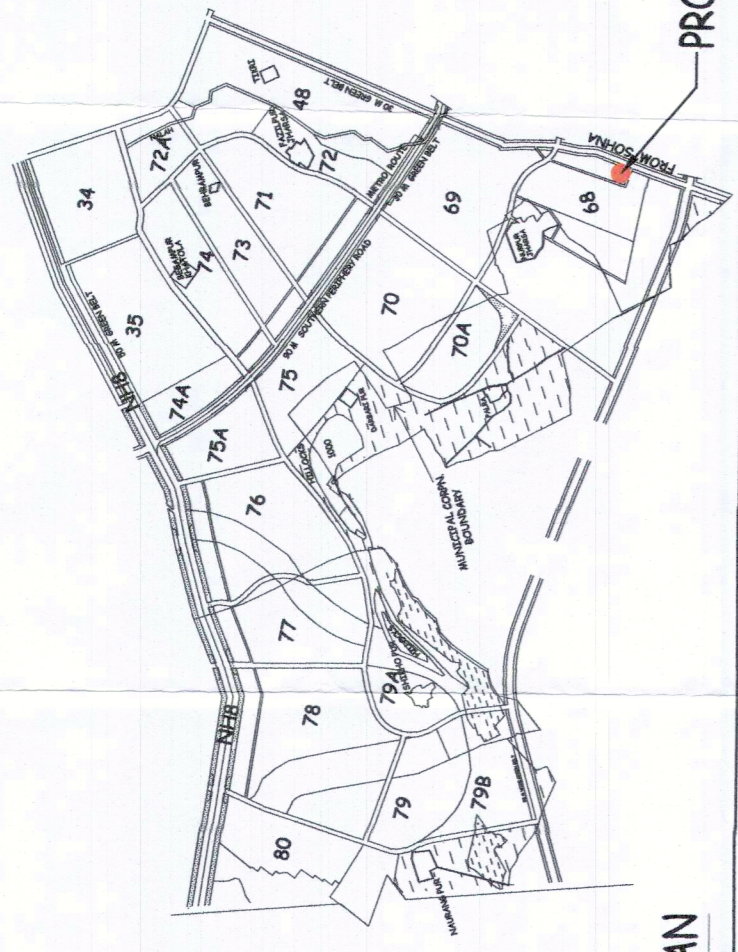

KEY PLAN

AREA CHART OF TOTAL SCHEME AREA

AREA DESCRIPTION		ACRES	SQ. MT.
DESCRIPTION	FACTOR		
SITE AREA		2.0000	8093.71
AREA GRANTED FOR FAR		1.49	6029.82
PERMISSIBLE G.C.	35% of 1.49	0.5215	2110.44
PERMISSIBLE F.A.R	1.50		9044.72
PROPOSED G.C.	35%		2110.38
PROPOSED F.A.R	1.50		9044.72
TOTAL NO. OF PLOTS			16
RATIO OF F.A.R DISTRIBUTION ON 15Q.MT. OF GROUND COVERAGE			4.286

DETAILS OF SCO'S (SECTOR 68)

TYPE	SIZE (M)		AREA		TOTAL NO. OF	TOTAL AREA (SQ.M.)
	LENGTH	WIDTH	SQM.	SQYDS.		
A	16.00	7.65	122.40	146	12	1468.80
B	19.08	9.25	176.49	211	2	352.98
C	16.30	9.25	150.78	180	1	150.78
D	14.90	9.25	137.83	165	1	137.83
GRAND TOTAL					16	2110.38

Sheet Title :-

## LAYOUT PLAN

Project

APPLICATION FOR MIGRATION OF 2.00 ACS.  
 INDEPENDENT COMMERCIAL LICENCE TO PLOTTED  
 COMMERCIAL COLONY LICENCE (as SCO's)  
 IN COMMERCIAL BELT OF SECTOR 68,  
 VILLAGE BADSHAHPUR, GURUGRAM (HARYANA)

SCALE	DATE	DRG NO.	NORTH
NTS	OCT. 2022	SCO/Comm. -01	

ARCHITECT  
 FAHAD SHAHBAZ  
 CA/2006/36330

ARCHITECT

AUTHORISED SIGNATORY